



क्षेत्रीय कार्यालय समस्तीपुर/REGIONAL OFFICE SAMASTIPUR

पहला तल्ला, पंचवटी कॉम्प्लेक्स, मोहनपुर रोड, समस्तीपुर, बिहार -848101

1<sup>st</sup> Floor, Panchwati Complex, Mohanpur Road, Samastipur, Bihar-848101

---

## INVITATION TO TENDERER

## INSTRUCTION TO TENDERERS

AND

## GENERAL CONDITIONS OF CONTRACT

FOR

## INTERIOR FURNISHING WORK & ELECTRICAL WORK

AT PREMISES OF

UNION BANK OF INDIA, KANTI BRANCH AND ATM, DIST-  
MUZAFFARPUR

## INDEX

SECTION-1 (TENDER NOTICE)

SECTION-2 (LETTER SUBMITTING TENDER FOR FURNISHING WORK)

SECTION-3 (SPECIMEN COPY OF AGREEMENT FOR FURNISHING WORK)

SECTION-4 (GENERAL CONDITIONS OF CONTRACT)

SECTION-5 (APPENDIX REFERRED TO IN THE GENERAL CONDITIONS)

SECTION-6 (TECHNICAL SPECIFICATION FOR FURNISHING WORK)

SECTION-7 (APPROVED MATERIAL SPECIFICATION FOR FURNISHING WORK)

SECTION-8 (BILL OF QUANTITIES FOR FURNISHING WORK)

SECTION-9 (FURNISHING WORK LAYOUT)

SECTION-10 (LETTER SUBMITTING TENDER FOR ELECTRICAL WORK)

SECTION-11 (SPECIMEN COPY OF AGREEMENT FOR ELECTRICAL WORK)

SECTION-12 (APPROVED MATERIAL SPECIFICATION FOR ELECTRICAL WORK)

SECTION-13 (BILL OF QUANTITIES FOR ELECTRICAL WORK)

SECTION-14 (ELECTRICAL WORK LAYOUT)



क्षेत्रीय कार्यालय समस्तीपुर/REGIONAL OFFICE SAMASTIPUR

पहला तल्ला, पंचवटी कॉम्प्लेक्स, मोहनपुर रोड, समस्तीपुर, बिहार -848101

1<sup>st</sup> Floor, Panchwati Complex, Mohanpur Road, Samastipur, Bihar-848101

**PRE-QUALIFICATION NOTICE**

Bank invites sealed tenders from currently empaneled vendors of any Nationalized Banks in respect of the below mentioned works at "Union Bank of India, KANTI Branch and ATM.

Work	<u>Branch and ATM Premises Furnishing/Furniture &amp; Electrical</u>
Eligibility	<u>Empaneled vendors with any Nationalized Banks can apply.</u>
Earnest Money Deposit	<b>Rs. 10000/- for Furnishing work, Rs. 5000/- for Electrification work</b> (Separate application will be submitted for Furnishing work & Electrical work) by Demand Draft from any Nationalized Banks payable at Samastipur and drawn in favour of Union Bank of India. (Refundable in case the tender is not accepted)
Document cost	Rs. NIL/- per application for every Branch and ATM (Non-Refundable) by Demand Draft from any Nationalized Banks payable at Samastipur and drawn in favour of Union Bank of India (Separate application will be submitted for Furnishing work & Electrical work for said Branch and ATM ) Document can also be downloaded from the Bank's website <a href="http://www.unionbankofindia.co.in">www.unionbankofindia.co.in</a> or from Government portal <a href="https://eprocure.gov.in">https://eprocure.gov.in</a> . However, for RFP document downloaded from website.
Period of Work Completion	03 Weeks / 21 days
Validity of Tender	21 days
Date of Issue of Tender	<b>From 29.06.2024 (During office hours) to 19.07.2024 (on or before 2.00 PM)</b>
Last date of submission of tender	Up to 2.00 PM on 19.07.2024
Date & Time of opening of Tender	Date: 19.07.2024 time 4.00 PM
Contact Email	<a href="mailto:pnd.roSamastipur@unionbankofindia.bank">pnd.roSamastipur@unionbankofindia.bank</a> (Mail us if any clarification)

In case, you are interested for the said work, you are requested to fill up the schedule of quantities (Tender paper format enclosed) for the said contract complete in all respect and submit in sealed separate envelopes clearly specifying "Tender for furnishing / furniture work of Union Bank of India KANTI Branch and ATM " and "Tender for Electrical work of Union Bank of India KANTI Branch and ATM "together with earnest money amounting (Refundable in case the tender is not accepted) in the form of draft, pay order / banker's cheque in favour of "Union Bank of India" and drawn on any nationalized bank at Samastipur to be deposited in this office on or before 2.00 PM, 19.07.2024 (Friday). The price / value should be quoted including taxes / transport charges etc. Those vendors who are interested to apply for Furnishing / Furniture and electrical works tenders have to submit their empanelment papers with any Bank, which is within validity period otherwise his bid may be rejected. The Bank reserves the right to accept or reject any or all tenders received in this regard without assigning any reasons whatsoever. Tenders received after the above date i.e. 19.07.2024 will not be entertained. It is pertinent to note that the vendors who are interested in work shall have to furnish entire work as per specification and well within time i.e. 21 days, otherwise Bank is free to charge penalty @0.5% of total cost per day after stipulated time period mentioned in work order.

**It is to be informed that all the other terms & conditions for accepting tender of your firm will be applicable as per our Bank's norms**

**Dy Regional Head**

## LETTER SUBMITTING TENDER

To,

-----  
 -----

Dear Sir.

With reference to the tender invited by you for the Furnishing work of premises of Union Bank of India, KANTI Branch and ATM under SAMASTIPUR region.

I/ We do hereby offer to execute the work under contract at the respective rates mentioned in the Schedule of quantities. I/We have seen the site, understood the general conditions of contract, schedule of quantities etc.

I /We agree to execute the work as per specification, general conditions of contract, special conditions, additional conditions, schedule of quantities etc.

I /We have deposited earnest money Rs. 10,000/- (Waiver in case of MSME vender) for furnishing work by demand draft which amount is not to bear any interest. We do hereby agree that this sum shall be forfeited by you in the event our tender is accepted, and I/We fail to execute the contract when called upon to do so.

I/We are understanding that you are not bound to accept the lowest or any tender that you receive.

Yours faithfully,

(SEAL &amp; SIGNATURE OF CONTRACTOR)

1). Name of Partner (s) of the firm: \_\_\_\_\_

2). Name of banker: \_\_\_\_\_

Demand Draft No. \_\_\_\_\_ Dated \_\_\_\_\_

Tender submitted on \_\_\_\_\_ before \_\_\_\_\_ P.M

## SPECIMEN COPY OF AGREEMENT

(Subject to change in order to availability from Central Office)

**For works exceeding Rs. 10.00 Lac agreement should be drawn on stamp paper.**

## ARTICLES OF AGREEMENT:

Agreement made at \_\_\_\_\_ this \_\_\_\_\_ day of \_\_\_\_\_ between Union Bank Of India Regional Office Samastipur, 1st floor,Panchwati Complex,Mohanpur Road, Samastipur-848101 (BIHAR) herein referred to as the successful tender/contractor which expression shall include his heirs, executors, administrators and assigns of the order part. Whereas UNION BANK OF INDIA, Regional Office Samastipur, 1st Floor, Panchwati Complex, Mohanpur Road, Samastipur, Bihar-848101 is desirous of carrying out of **the Furnishing of premises of Union Bank of India, KANTI Branch and ATM** , and has caused specification etc. describing the work to be done as per schedule of quantities along with the general conditions of contract, special condition, additional conditions etc. and whereas the contractor has agreed to execute the work described in said priced schedule of quantities, general conditions of contract, special condition, additional condition at the respective rates mentioned in the priced schedule of quantities attached.

Whereas the contractor has deposited Rs. **10,000/-** (Waiver in case of MSME vender) with the UNION BANK OF INDIA, Regional office, Samastipur, 1st floor,Panchwati Complex,Mohanpur Road, Samastipur-848101 (BIHAR) as earnest money for due performance of the agreement.

## NOW IT IS HEREBY AGREED AS FOLLOWS:

1. In consideration of the payment to be made to the contractor as herein provided he shall upon and subject to the said conditions execute and complete the work as per the said conditions and priced schedule of quantities.
2. The UNION BANK OF INDIA, Regional Office Samastipur, 1st floor,Panchwati Complex,Mohanpur Road, Samastipur-848101 (BIHAR) shall pay the contractor such sums as shall become payable hereunder at the times and in manner specified in the conditions.
3. The said conditions shall be read, and form part of the agreement and the parties hereto shall respectively abide by and submit themselves to the conditions and stipulations and perform the agreement on their parts respectively on such conditions contained.
4. All disputes arising out of in any way connected with this agreement and the parties hereto shall respectively abide by and submit themselves to the conditions and stipulations and perform the agreement shall be deemed to have arisen in Samastipur and only the Court / Arbitrator in Samastipur Shall have jurisdiction determine the same.
5. The several parts of this contract have read to us and fully understood by us.

(WITNESS

UNION BANK OF INDIA, Regional Office SAMASTIPUR

(CONTRACTOR)

## **GENERAL CONDITIONS FOR BOTH WORK**

1. Sealed tenders should be addressed to The Regional Head, UNION BANK OF INDIA, Regional Office SAMASTIPUR, 1st floor,Panchwati Complex,Mohanpur Road, Samastipur-848101 (BIHAR) and super scribe **Name of Work "FURNISHING WORKS OF PREMISES OF UNION BANK OF INDIA, KANTI Branch and ATM "** and **ELECTRICAL WORKS OF PREMISES OF UNION BANK OF INDIA, KANTI Branch and ATM "** separately and should reach the office before 2.00 PM on 19.07.2024.
2. Duration of Tender from 29.06.2024 to 19.07.2024 and last date for submission of tender on 19.07.2024 till 2.00 PM. No tenders shall be received after 2.00 P.M on 19.07.2024 and the tenders will be opened on 19.07.2024 by 4.00PM.
3. Any clarification (in Writing) whatsoever shall be sought from the Architect, minimum two days before the tender submission date.
4. The tender shall remain valid for a period of 2 months from the date of opening of tenders UNION BANK OF INDIA, Regional Office SAMASTIPUR, 1st floor,Panchwati Complex,Mohanpur Road, Samastipur-848101 (BIHAR) and reserves the right to accept or reject any or all the tenders without assigning any reason to do so.
5. At the time of submission, every tender must be accompanied by a Demand Draft of **Rs.10,000/-** for furnishing work and **Rs. 5000/-** for electrical work in favour of UNION BANK OF INDIA, Regional Office SAMASTIPUR as Earnest Money Deposit and No interest shall be paid on earnest money. Any tender which is not accompanied by the earnest money shall be summarily rejected. **Firms registered with National Small Industries Corporation (NSIC) submitting valid proof documents would be exempted from payment of Earnest Money Deposit.**
6. The tender should quote the rates in figures as well as in words.
7. All erasures and alterations made while filling the tender must be attested by initials of Tenderer. Overwriting of the figures in not permitted.
8. The earnest money deposit of unsuccessful tenders shall be returned after the tender is decided or on expiry of validity period.
9. The earnest money of the successful tender shall be adjusted in the initial security deposit.
10. The UNION BANK OF INDIA, Regional Office SAMASTIPUR, 1st floor,Panchwati Complex,Mohanpur Road, Samastipur-848101 (BIHAR) and reserved right to reject any or all the tenders accept part of any tender or entrust the entire work to any contractor or divide the work to more than one contactor (item wise) without assigning any reason or giving any explanation . The rates quoted by the contractor shall hold good for this bifurcation and no compensation shall be paid on this account.
11. Joint tenders shall not be considered.
12. On receipt of intimation from the **Union Bank of India, Regional Office SAMASTIPUR**, 1st floor,Panchwati Complex,Mohanpur Road, Samastipur-848101 (BIHAR) of the acceptance of his tender the Tenderer should acceptance of the work order within 3-days. If the successful Tenderer fails to undertake the work, the earnest money deposited by him shall be forfeited and acceptance of his tender may be withdrawn.
13. The rates quoted in the tender shall include all charges of shifting of furniture, scaffolding, ladder, lift up and down mechanical transportation, loading ,unloading ,any or special tools and plants railway freight , labor taxes etc. it shall also take care other taxes of expenditure for carrying out the work. The rate quoted in the tender shall also include for the charges for carrying out various types of laboratory / site tests for different types of materials.
14. The Contractor shall arrange water and electricity for completing the work.
15. No escalation in rates shall be allowed under any circumstances.
16. The successful Tenderer is bound to carry out carry out entire work within the period stipulated in the Appendix. The Tenderer shall have to pay liquidated damages for non-completion of job within

stipulated period, Bank is free to charge penalty @0.5% of total cost per day after stipulated time period mentioned in work contract.

17. The liquidated damages as mentioned above may not be enforced if the contractor applies for extension of time mentioned the reasons for extension. Extension of time in days shall be granted by the UNION BANK OF INDIA, Regional Office SAMASTIPUR, 1st floor, Panchwati Complex, Mohanpur Road, Samastipur-848101 (BIHAR) and if it is proved that contractor is not at fault for extending the work beyond stipulated date of completion.
18. The Successful Tenderer is bound to carry out items of work necessary for completion of job even though the same are not included in the schedule of quantity. Rates of extra items shall be derived from the tender. In case the rates do not exist in the tender and extra item is not similar to tender item. Then the rates shall be worked out on the prevailing market cost of material and Labour including wastage plus 15% towards tax and Contractor's profit.
19. The Contractor must co-operate with other contractor appointed by the UNION BANK OF INDIA, Regional office 1<sup>st</sup> floor, Panchwati Complex, Mohanpur Road, SAMASTIPUR — 848101 (BIHAR) and so that entire work shall proceed smoothly with least possible delay and to the satisfaction of the UNION BANK OF INDIA, Regional Office SAMASTIPUR, 1st floor, Panchwati Complex, Mohanpur Road, Samastipur-848101 (BIHAR)
20. The Contractor shall remove all wastes etc. wash and clean the floors regularly at his own cost and hand over the site in proper manner on the completion of work.
21. The Tenderer is advised to visit the site and acquaint himself with the site conditions making his own arrangement for storing of material at site lift, cartridge, etc.
22. The initial security deposit shall be made, @ 2% of the accepted contract value less (subtracting) earnest money deposit, by the successful Tenderer within 07 days of acceptance of his tender. It shall be submitted in form of Bank Draft in favor of Union Bank of India payable at SAMASTIPUR
23. The Successful Tenderer shall have to enter into an agreement with the bank.
24. 8% of the value of work done shall be deducted as retention money from the interim payments made to the contractor, and shall be retained for defects liability period (mentioned in the Appendix) and shall be released after the defects liability period, provided no defects are noticed during the period. This retention money along with earnest money deposit and initial security deposit would make the security deposit to be deposited by the contractor.
25. The contractor shall attend to all defects noticed during liability period. If the contractor fails to attend the defects, these defects shall be rectified by the UNION BANK OF INDIA. Regional Office SAMASTIPUR, 1<sup>st</sup> floor, Panchwati Complex Mohanpur Road, Samastipur— 848101 (BIHAR) and the expenditure incurred on this account shall be recovered from security deposit.
26. The contractor shall make adequate arrangement for watch and ward of his material and shall ensure the safety, breakage and any of their materials fixed or unfixed by him or other sub-contractors.
27. The Work executed should be got approved by the UNION BANK OF INDIA, Regional Office SAMASTIPUR, 1st floor, Panchwati Complex, Mohanpur Road, Samastipur-848101 (BIHAR) and contractor shall rectify any bad workmanship pointed out at any stage and remove from site all the rejected materials immediately.
28. The contractor shall be responsible for application of Labour laws, compensation for injury and accident to person, whether employed by him or by his sub-contractor.
29. The contractor shall take necessary precautions for carrying out the work avoiding any damage to structures/decorative parts of the property. The contractor shall rectify damages done at his cost
30. The contractor shall ensure that workmen employed by him for execution of work are suitably covered against workmen's compensation Act and that all liabilities arising out of workmen's compensation Act, ESIS and other legislative enactment application to such works and workmen shall be to the contractor's account. The contractor shall also ensure that he has gone under the closer of all sorts of insurance that are subjected to the said job, before commencing the job.

31. Furnishing, Civil, water supply, FURNISHING and Demolition works shall be carried out as per drawing /specifications and to the entire satisfaction of the UNION BANK OF INDIA, Regional Office SAMASTIPUR, 1st floor,Panchwati Complex,Mohanpur Road, Samastipur-848101 (BIHAR) and the Architect.
32. The contractor shall give due notice to the UNION BANK OF INDIA to check measurements of any which is likely to be hidden before covering the same.
33. The Contractor shall submit running bills for the value of work done mentioning full nomenclatures of items, rates, amount, measurements sheets, reasons, for part rates claimed, if any.
34. In case of non-completion or delay in completion of work or removal of defects in time the UNION BANK OF INDIA, Regional Office SAMASTIPUR, 1<sup>st</sup> floor, Panchwati Complex, Mohanpur Road, Samastipur— 848101 (BIHAR) shall be appoint another agency to get the job done at contractor's risk and cost.
35. For fixed as well as loose furniture, rates quoted by the contractors shall be inclusive; octroi transportation etc. and no extra amount shall be paid on this account. GST shall be paid by the Bank
36. Income-tax (TDS) at the rate of 2% (or as applicable from time) of the bill amount shall be deducted at source from the contractor's bill and shall be deposited with the I.T.O as per rules.
37. The UNION BANK OF INDIA, Regional Office SAMASTIPUR, 1st floor,Panchwati Complex,Mohanpur Road, Samastipur-848101 (BIHAR) may delay the progress of work without. in any vitiating the contract and grant such extension of time for the commencement / completion of the contract as it may think proper and sufficient in consequence of such delay and contractor shall not make claim for compensation or damage in relation thereof.
38. The contractor shall not execute any extra item without UNION BANK OF INDIA, Regional Office SAMASTIPUR, 1st floor,Panchwati Complex,Mohanpur Road, Samastipur-848101 (BIHAR) permission in writing.
39. The quantities mentioned in the schedule of quantities are approximate. Payment shall be made on actual work done by the contractor. However, the contractor should not deviate the quantity without UNION BANK OF INDIA, Regional Office SAMASTIPUR, 1st floor,Panchwati Complex,Mohanpur Road, Samastipur-848101 (BIHAR) permission.
40. Conditional tenders quoted by the Tenderer are liable to be rejected.
41. The UNION BANK OF INDIA, Regional Office SAMASTIPUR, 1st floor,Panchwati Complex,Mohanpur Road, Samastipur-848101 (BIHAR) has a right to alter the nature of work and to add or omit any items of work or to have the option of the same carried out departmentally or otherwise and such alterations or variations shall be carried out without prejudice to this contract.
42. In case the particular make of material mentioned not available at the time of execution of the work ,the alternative make of materials shall be got approved from the UNION BANK OF INDIA, Regional Office SAMASTIPUR, 1st floor,Panchwati Complex,Mohanpur Road, Samastipur-848101 (BIHAR) /Architect before its use.
43. Arbitration —In case of any dispute between UNION BANK OF INDIA, Regional Office SAMASTIPUR, 1st floor,Panchwati Complex,Mohanpur Road, Samastipur-848101 (BIHAR) & contractor, the decision taken by the arbitrator who shall be appointed by the UNION BANK OF INDIA, Regional Office SAMASTIPUR, 1st floor,Panchwati Complex,Mohanpur Road, Samastipur-848101 (BIHAR) shall be final.

**(Union Bank of India, Regional Office, Samastipur**

**(Contractor)**



**SECTION-5**

**APPENDIX REFERRED TO IN THE GENERAL CONDITIONS**

Defects liability period: -	12 Months
Date of commencement: -	2nd day from the date of issue of letter awarding the job
Stipulated period for completion: -	21 days from the date of work order.
Initial security deposit till completion of work (ISD): -	2% of the accepted contract value.
Retention Money: -	8% to be deducted from Interim payment.
Security deposit for defects liability period: -	The Security deposit shall be worked Out as under- $(SD)=EMD+ISD+RM$

LI Liquidated damages for non-completion of work within stipulated period. The Tenderer shall have to pay liquidated damages for non-completion of job within stipulated period at the rate of 0.5% of total cost of contract per day after stipulated time period mentioned in work order.

**TECHNICAL SPECIFICATION FOR FURNISHING AND MINOR CIVIL WORKS**

1. While quoting rate for item of work, the contractor shall also include for the following irrespective of whether it has been mentioned or not in the detailed specifications of the item. The contractor shall not be paid any extra cost.

All ply board /plywood/door shutters used shall be phenol bonded, exterior (BWP) grade Confirming To latest relevant IS codes shall be used.

All unexposed surface of wood /ply board/plywood (any variety) used shall be treated with necessary coats of anti-termite treatment.

All unexposed surface of wood /ply board/plywood (any variety) used shall be treated with synthetic enamel of approved make unless otherwise specified.

All metal work shall be treated with anti-corrosive treatment.

All exposed edges of wood (any variety) shall be finished with wood primer / putty and paint/melamine finish /distress stain police etc.

All exposed edges of wood /ply board / plywood (any variety) used shall be finished with 6.0 mm thick teakwood lapping unless otherwise specified.

All brass work, fitting & fixtures shall have lacquered finish.

2. The specifications which are not included in the technical specifications mentioned in the tender shall be as per ISI specifications/ Instruction of Employer / Architect.
3. Thickness used shall be as following unless otherwise specified

Laminated used shall be 1.0 mm thick.

Teak or cedar veneer /ply used shall be 4.00 mm thick.

Waterproof ply shall be 9/6 mm thick as required

Waterproof board shall be 19 mm thick.

4. The contractors are advised to refer the drawings for dimensions, sizes, etc., to cross check the BOQ and then quote accordingly.

Any substandard materials used during the execution shall be rejected. The contractor shall replace the same to the entire satisfaction of the UNION BANK OF INDIA, Regional Office SAMASTIPUR. The Tenderer shall have to pay liquidated damages for non-completion of job within stipulated period at the rate of 0.5% per day of total cost after stipulated time period mentioned in work order.

5. The contractor of his authorized representative shall remain at site supervise the total project. The representative shall always bear a copy of authority letter from the contractor and a copy of it shall be submitted to Branch Manager.

6. The contractor shall also submit an undertaking to the Branch manager mentioning that he shall bear the total responsibility for any sort of injury or physical damage done to the sub structure and ground floor, nearby structures, workmen employed at site staff member of bank, public coming to bank, residents staying nearby, passerby etc. Bank does not hold any responsibility for any sort of disputed or accident, which has arisen from the said job. All of them shall be on the contractor's account.
7. The Contractor shall not be paid extra for making of any cut out /opening for FURNISHING/air conditioning wiring/fitting in any of the item of false ceiling, partitions, paneling, skirting, masonry work etc.
8. The contractors shall fabricate and submit, at site, one or more samples of each item as instructed by UNION BANK OF INDIA, Regional Office SAMASTIPUR. The Tenderer shall have to pay liquidated damages for non-completion of job within stipulated period at the rate of Rs 1,000/- per day for the first week and Rs 2,000/- per day after that, with a maximum limit of 5% of the total contract value. / Architect for approval. The bulk production of each item shall be taken in hand only after the final approval of sample of each item. It shall be the entire responsibility of the contractor to get the sample approved by the UNION BANK OF INDIA, Regional Office SAMASTIPUR / Architect spending the minimum time and no extension of time shall be granted for getting the late approval of samples. The approved sample shall be kept at site in the custody of the UNION BANK OF INDIA, Regional Office SAMASTIPUR (Bihar) and Architect. However, the same shall be taken back by the contractor after the completion of work in all respects.
9. The contractor, whenever asked shall submit basic unit rates of all constituent materials and Labour required for completion of any particular item. These rates shall be for the analysis of any extra or substituted items.
10. Openings in partitions / paneling/ ceiling etc. shall be deducted as per specifications.

The following makes of materials shall be used in the works. In the event of non- availability of certain items, the approval of the Architect/ Employer must be obtained in the writing prior to using substitute make:

**LIST OF APPROVED MAKES OF MATERIALS:**

SL NO	ITEM	MAKE
1	BWR/MR/marine plywood and Flexi Ply (ISI 303)	I. Century ply II. Kajaria ply III. Austin ply IV. Duro ply
2	Block Board	I. Century ply II. Kajaria ply III. Austin ply IV. Duro ply
3	Flush Doors	I. Century ply II. Kajaria ply III. Austin ply IV. Duro ply
4	Laminate	I. Marino II. Archid III. Century IV. Greenlam
5	Locks	I. Godrej II. Link III. Dorset
6	Floor Springs/Door Closers/Patch & Spider Fittings	I. Ozone II. Ebco III. Dorset
7	Glass	I. Saint Gobin glass II. Modi glass
8	SS Hinges	I. Kich
9	Door Stoppers	I. Kich II. Ebco
10	Door Closure	I. Ozone, II. Ebco , III. Dorset
11	Telescopic Channels & SS brushed finished studs, Cable Manger	I Ebco ii. Hettich
12	Anti Termite	I. Nocil II. Shalimar
13	AL. Section (partition frame)	I. Jindal II. Indal
14	Blinds	I. Vista Levolor, Mac
15	FALSE CEILING	I. Armstrong –classic RH98 (Mineral fibre ceiling) II. India gypsum, III. Saint Gobin



2	<p><b>(HALF HEIGHT PARTITIONS-FULLY PANELLED) (4'6" ht)</b>  Providing and fixing half height double skin partitions in cabins etc, with frames of 2" x 2" (finished size) seasoned hardwood members (hollock / malaysian sal) at max. intervals of 1'-6" x 1'-6" c/c with provision of bigger members at skirting, fixing to door frames, etc, all wood work to be treated with 1st quality anti-termite paint, and 6 mm thick commercial BWR Plywood of approved make covered with various finishing layers as per design and details including 1 mm thick laminate of approved make. Above 3'-0" level fix 8.0 mm thick etched glass as per design (All visible wood to be of 1st quality "gamhar") and shall be painted with Premium 1st quality paint / polished as per instructions of Bank</p>				
	Ghambhar Frame shall be neatly painted / polished to a glossy finish with premium quality paint / polish. All necessary hardware such as hinges, bolts, etc, and any other hardware required for the wicket door, shall be included in the price.				
	Laminates shall have a number of horizontal / vertical grooves and the ply under such grooves shall be painted with approved colours.				
	Openings for communication / conversation shall be provided as required as per detailed design and nothing extra shall be paid / deduction for the same.				
	All electrical wires, accessories, telephone wires, etc, shall be run in the partition without any extra charges for the same.				
	All doors including sliding doors / openable doors, with all fittings including ISI Marked Floor Springs, Hinges, Bolts, etc., shall be included in the same price. Doors shall be of heavy sections matching the partition, and shall have 8.0 mm thick etched glass as per design.				
	All items necessary for completing the above mentioned work are deemed to be included in the scope of work, whether or not they are specifically mentioned in the B.O.Q / tender documents / drawings.				
	All exposed wooden surfaces are to be painted with Premium quality paint as per Specifications.	SQ.FT.	92.00		
3	<p><b>(COMPUTER CASH AND CASH CAGE PARTITIONS - FRONT)</b> Providing and fixing cash cage glazed partition on top of cash counter facing the customer with 12 mm thick clear float glass (Modiguard) fixed in a frame of 2" x3" teakwood on all three sides, duly polished, all beading etc. as required, all cutting of glass as required, all complete.</p>	SQ.FT.	35.00		
4	<p><b>(COMPUTER CASH AND CASH CAGE PARTITIONS - SIDES &amp; REAR)</b> Providing and fixing cash cage partition, as per specifications given in Item No. 1a above, modified in height and the openings required to suit the requirements of cash cages, with the exception that in addition to 5.0 mm glass, aluminium mesh shall be given in all cash cage partitions, etc, from 4'-0" to 7'-0", along with supporting members all doors, as per specifications given in Item No. 1 above, all hardware for doors which shall be paid for separately, all complete. The front of the cash cage shall be done in a decorative design, as shown in the attached drawings and details.</p>	SQ.FT.	216.00		
5	<p><b>OFFICER COUNTER GLASS - (front) -</b> Providing and fixing glazed on top of cash counter facing the customer with 12 mm thick clear float glass (Modiguard) fixed in a frame of 2" x3" teakwood, duly polished, all beading etc. as required, all cutting of glass as required, all complete as/specificain and direction. (glass size. 4'-6"X1'6" above table top)</p>	SQ.FT.	27.00		

6	<b>(ALUMINIUM MESH ON TOP OF CASH CAGE)</b> Providing and fixing aluminium mesh cage on top of cash cage area, all complete with polished gambhar wood frame, duly supported at regular intervals to prevent sagging, all complete.	SQ.FT.	70.00		
7	<b>(HYDRAULIC DOOR CLOSER)</b> Providing and fixing Hydraulic door closers of specified brand, all complete as per instructions of Architect / Employer.	Each	6.00		
8	<b>(LOCKS)</b> Providing and fixing "Godrej Night Latch" / "Godrej Mortice Lock" in required places, all complete with fixing, fitting, etc.	Each	6.00		
9	<b>(EXECUTIVE TABLES)</b> Providing and Placing new executives tables alongwith matching credenza of plan size (basic) as given below and credenza of plan size as given below, table top to be made of 19 mm thick commercial plywood of approved make, edged with beading of 2" x 1-12" approx), cut to required shape, top of table to have 1.0 mm thick laminte, and teakwood beading to be polished to required colour and finish. Table to have a vertical modesty panel of 19 mm thick commercial plywood of approved make laminated/Plain with laminate (1.0 mm thick) from the outer side and painted with minimum 2 coats of premium 1st quality paint on the inner side. Modesty partition to have 1st quality beading on top as per design and specifications and Quality Enamel paint over appropriate priming coat on the internal surface.				
	Laminate to have a no. of grooves as per design andt s drawings. Achest of drawers shall support the table on 1 side (except in the case of staff tables of 4'-0" width, where the table shall be supported on one side by the credenza unit) integrally connected to the modesty partition, made of 19 mm thick commercial plywood of approved make, drawers to slide on drawer slides (EBCO / Equivalent), and made of 19 mm thick grade bwp board for all sides and bottom cabine shutters of 19 mm thick commercial plywood of approved make, cabinet hinges to be t-type, self closing, EBCO / Equivalent, all edges of all blockboard / plywood to be sealed with 1st quality teakwood edging, including blockboard members touching the ground.				
	Drawers and cabinet shutters to be laminated on all external surfaces with 1.0 mm thick laminate, and painted on all visible internal surfaces with premium 1st quality enamel paint as Specified above.				
	All drawers and cabinets (both in tables and credenza) to provided with high quality 'Gogrej' locks, and high quality handles as per Item No. B above.				
	The other end of the table to be supported / integrated with a credenza unit of basic 2'-6" height, or as required, top, back and sides made out of 19 mm thick commercial plywood of approved make laminated/Plain , top to be finished with 1.0 mm thick laminate and teakwood beading o/o 1" x 1", carved as per design, and finished as per table Specifications above.				
	Drawers and cabinets, cabinet shutters, etc. to be as described in table specifications above, including all finishing details, and one glazed cabinet shutter in 1st Quality Teakwood frame, finished with laminate also to be laminated with 1.0 mm thick laminate grooves as / design.				
	Keyboard unit as per design and specification to be included in the rate.				
(a)	Manager (6'-0" x 3'-0")	Each	1.00		
(b)	Officer (5'6"x2'6")	Each	0.00		

(c)	Officer (5'0"x2'6")	Each	0.00		
(d)	Officer (4'9"x2'6")	Each	0.00		
(e)	Officer (4'6"x2'6")	Each	3.00		
(f)	Officer (4'3"x2'6")	Each	0.00		
(g)	Credenza (1'3"x4'0")	Each	2.00		
(h)	Credenza (1'3"x3'6")	Each	0.00		
(i)	Credenza (1'3"x3'3")	Each	0.00		
(j)	Credenza (1'3"x3'0")	Each	4.00		
(k)	Credenza (1'3"x2'3")	Each	0.00		
(l)	Full Ht cabinet;-(elevation area calculation))	SQ.FT.	102.00		
(m)	Sill Ht cabinet;-(elevation area calculation))	SQ.FT.	58.00		
(n)	Centre table (3'0"x2'0")	Each	0.00		
10	<b>(COUNTERS)</b> Providing and fixing COMPUTER COUNTERS (formerly from as LEDGER COUNTERS) made out of 19 mm thick commercial plywood of approved make and as per the attached drawing, all complete with 1.0 mm thick laminate (Greenlam/Century) on all visible surface, tabletops, customer top, etc, and all drawers etc. to be painter with 1 coat of primer and 2 coats of 1st quality enamel paint). 12 mm thick glass, MODIGUARD/ASAHI, branded, to be used on top of the COMPUTER COUNTER. Keyboard Tray to be provided on Special Keyboard Slides, and wristrest to be given. Drawer Slides to be used for all drawers. All locks to be of Godrej / Linc. All drawers, cabinets, Keyboad, etc. to be lockable. Footrest to be provided. (See Detailed drawing attached). The Front of the Computer Counter shall have decorative finishing in ply and laminate as shown in the drawing attached.	R.Ft.	0.00		
11	<b>(CASH COUNTERS)</b> Providing and fixing Cash Counters, to be made entirely of 19 mm thick commercial plywood for all surfaces, with the working top of 3'-6" width at 2'-6" level, and the customer top of 1'-6" width at 4'-0" level. Chest of drawers (lockable) with Godrej / Links to be provided and on cabinet just below drawer. The working top to be 3'-0" wide, fully detailed out with overhangs and supports as per detail drawings, all edges to be sealed with teakwood beading, polished / painted as per directions, all complete with footrest of ghambhar wool of section 4" x 2", all complete with all hardware, supporting clips, etc. The front of the Counter shall have decorative features, all complete, as per the designs and drawings attached.	R.Ft.	9.00		
12	<b>(NOTICE BOARD)</b> Providing and fixing a notice board near the Waiting area, frame to be made of 1st quality hardwood, and infill of 12 mm thick 'Celotex, board, duly covered with "Matte" quality cloth of approved colour and make. Visible surfaces of Frame to be painted with "Premium 1st Quality Paint" in approved colour and shade, and internal frames and internal surface of celotex board to be painted with priming coat. The frame is to be securely fixed to the wall, all complete as per directions for the Architect / Employer. (Size: 3'-6" x 2'-0").	Each	2.00		



13	<b>(MAIN ENTRANCE DOOR)</b> Providing Factory Made Aluminium Main Entrance Door of INDAL / Jindal sections, minimum section thickness of 2.5 mm all complete with swing door, fixed portion all 8mm thick glass,and 12 mm Toughened glass for opning door, coloured anodized / powder coated, as per standard aproved sections, all complete with all necessary hardware and fittings, including floor springs, door locks, etc Make.Glass (Saint Gobain glass,Modi glass,Asahi)	SQ.FT.	156.00		
14	<b>(SUGGESTION BOX)</b> Providing and fixing one suggestion box, made with 12 mm ply as per standard design and specifications of the Bank, fully complete, with enamel painting, lock, lettering on top, etc.	Each	1.00		
15	Providing and fixing Cheque writing/slip rack projected/supported from wall 6'-0" x1'-3" and a C.T. as per design with suggestion box,first aid box,sugestion box.	Each	1.00		
16	<b>(CHECK DROP BOX)</b> Providing and fixing one suggestion box, made with 12 mm ply as per standard design and specifications of the Bank, fully complete, with enamel painting, lock, lettering on top, etc.	Each	1.00		
17	<b>Planter</b> -size 1'6"x1'6"x1'3" with 19mm board,1mm laminated & 12mm rubber wood all as per design	NOS	0.00		
18	<b>(SOFA)</b> Providing and Placing sofas of a contemporary design, the basic frame of which is to be made of 1st class hardwood, supports of 19 mm thick marine grade bwp plywood, covered with thick layers of hi-density foam, shaped to the required design, and covered with hi-quality fabric of the basic range of Rs. 250/- per metre. Each sofa seat to be approximately 2'-0" x 2'-0" in size, the overall sofa to be a highly luxurious look and feel, and to be comfortable to sit. <b>3 Seater sofa.</b>	Each	0.00		
19	<b>(SOFA)</b> Providing and Placing sofas of a contemporary design, the basic frame of which is to be made of 1st class hardwood, supports of 19 mm thick marine grade bwp plywood, covered with thick layers of hi-density foam, shaped to the required design, and covered with hi-quality fabric of the basic range of Rs. 250/- per metre. Each sofa seat to be approximately 2'-0" x 2'-0" in size, the overall sofa to be a highly luxurious look and feel, and to be comfortable to sit. <b>2 Seater sofa.</b>	Each	0.00		
20	<b>(Column Panelling)</b> : Column panelling within 1 ½"X1" hardwood fixed to the column and then finished with 6mm ply & above should be laminated with 1.5mm laminate of approved make and as per drawings and instruction of the architect. A wooden cornice of size 3"X2" has to be fixed on the edge and around the pillar as per design duly polished as per instructions of the Architect. (upto 7'0" height/False ceiling) .	SQ.FT.	0.00		
21	<b>(Vertical blinds)</b> :Providing & fixing levelor 10mm vertical blinds having top rail 39mmX34mm hjgh with wall thicknessof 1.2mm having 25mm decorative insert. Control unit shall be of Derlin. Plastic runner shall be moulded from Derlin plastic with artification head rail & the top end of the louver fabric shall be polyster viscose/polyster yarn dyed in fast colour with or without protective coating on louvers with chemical for stain resistance and soil repetancy and shall have GI weight and steel/polymer ball chain for spacing. The top rail should be fixed on bracket of 14 SWG galvanized spring steel fixed firmly on walls by nylon plug and screw as per approved design and direction of the Architect.	SQ.FT.	0.00		

22	<b>(PANEL BOX COVERING)</b> Shall be made up of 19mm th BWR boarer free ISI marked -Fire resistant ply on all the sides. shutter shall be of 19mm th block board of BWR grade ISI marked-Fire resistant (Minimum 2 hr.) and shall have holes 1/2" dia ( 25nos.) for ventilation and have glass piece (9"x9") for meter reading and shall be finished with 1.00mm laminate of approved shade on all exposed sides and inside finished with two coats of synthetic enamel paint with two coats of primer. The rate is inclusive of all locks of Godrej or equivalent make, SS tower bolts, SS handles, heavy duty SS hinges etc.all hardware complete. Prior confirmation shall be obtained from the officer in charge for all the hardware, locks and fixture etc., complete. ( Note :- Box should not touch the ground)	SQ.FT.	21.00		
23	<b>(SHUTTER BOX COVERING)</b> Sutter covering with ACP (aluminium composite panel) of approver color & make with the provision of rolling shutter maintenance trap door , all complete job as per standard & specification	SQ.FT.	96.00		
24	<b>GYPSON BOARD FALSE CEILING</b>	SQ.FT.	362		
i	Providing and fixing GYPSON BOARD FALSE CEILING in levels as per the detailed drawing - made up of G.I frames as specified by Gypsum India limited and 12mm thick Gypsum board with suitable suspenders fixed to the ceiling. Ceiling section, perimeter channel, suspenders etc. shall be standard sections supplied by Gypsum India LTD. Spacing of intermediate channels shall be at 1200 mm c/c, and ceiling section at 457 mm c/c the work includes taping and jointing, applying primer, two or more coats of plastic emulsion paint of approved shade ICI/ASHIAN PAINTS make, making cut-out for light fixtures, etc. The Final court shall be done with FOAM ROLLER, and no brush marks should be visible. Providing of perimeter channels/ beading etc. as per drawing complete in all respects.(All measurement in sqft only)				
	The rate should include necessary additional ceiling sections and intermediate channels openings for light fixtures, A.C. ducts, vertical drops, offsets.and with two coats of putty, two coats of approved primer, and three coats of approved lustre paint				
ii	Specification same as above for Vertical band of Gypsum 4" -6" BAND	R.FT.	124		
iii	<b>GRID FALSE CEILING-(SAINT GOBIN /ARMSTRONG DUNE RH-98)</b>	SQ.FT.	488		
	Providing and fixing of false ceilings at all heights of 600 mm x 600 mm x 10-12 mm Mineral Fibre ceiling tiles of type Premier-Beveled Tegular Edge laid on 15mm exposed grid system.The framework comprise of main runner spaced at 1200mm centers securely fixed to the structural soffit by approved hangers at 1200mm maximum centers. Hangers (GI wire of 4.0mm dia) to be fixed by approved roof plug, level adjusters and screws etc. The last hanger at the end of each main runner should not be greater than 450mm from the adjacent wall. Flush fitting 1200mm long cross tees (with double stitching) to be interlocked between main runners at 600mm centers to form 1200 x 600mm modules. Cut cross tees longer than 600mm to be supported independently. 600mm x 600mm modules to be formed by fitting 600mm long flush fitting cross tees centrally between the 1200m cross tee.(as per approved from work incharge)				
	<b>TOTAL (A)</b>				

ATM WORK(B)					
Sl. No.	DESCRIPTION	UNIT	QTY.	RATE	AMOUNT
1	<b>(FULL HEIGHT PARTITION) (Semi Glazed /Solid partition)</b> Providing and fixing fullheight double skin partitions in cabins etc, with frames of 2" x 2" (finished size) seasoned hardwood members (hollock / malaysian sal) at max. intervals of 2'-0" x 2'-0" c/c with provision of bigger members at skirting, fixing to door frames, etc, all wood work to be treated with 1st quality anti-termite paint, and covered with 6 mm thick commercial BWR Plywood of approved make covered with various finishing layers as per design and details including 1 mm thick laminate of approved make. (All visible wood to be of 1st quality "ghambhar") and shall be painted with Premium 1st quality paint / polished as per instructions of Bank				
	Laminates shall have a number of horizontl / vertical grooves and the ply under such grooves shall be painted with approved colours.				
	<b>Semi Glazed Partition</b> -The partition between the level 3'-3" to 7'-0" mm have 8 mm thick Float glass with etching film as per design. Glass panel as an insert with 3 1/4"x1" thk.beach wood (BW) beading with melamine spray polish including all hardwares etc. complete. .The partition should be firmly fixed on floor/ counter/ wall.				
	Opening for communication / conversation shall be provided as required as per detailed design and nothing extra shall be paid / deduction for the same.				
	The height of the partition shall be measured upto the R.C.C. Ceiling, if applicable. For False ceiling area ,height of the partition shall be measured upto the false ceiling.				
	All doors including sliding doors / openable doors, with all fittings including ISI Marked Floor Springs, Hinges, Bolts, etc., shall be included in the same price. Doors shall be of heavy sections matching the partition, and shall have 8.0 mm thick etched glass as per design.				
(i)	<b>Semi Glazed Partition</b>	SQ.FT.	0.00		
(ii)	<b>Solid Partition</b>	SQ.FT.	102.00		
2	<b>FULLY GLAZED 12MM GLASS PARTITION BETWEEN MACHINES (5'-6")</b>	SQ.FT.	0.00		
	Providing and fixing 12MM thick plain glass partition with etching (glass of approved shape cutting as / instruction) between the two machines. The glass will be fixed with 6"x2" c.p.t. wood bottom runner finished with approved colour laminate alongwith stainless steel 'D' Bracket. Complete as per instructions of the architect. All complete as per detail drawing and instructions of architect.				
3	<b>(HYDRAULIC DOOR CLOSER)</b> Providing and fixing Hydraulic door closers of specified brand, all complete as per instructions of Architect / Employer.	Each	1.00		
4	<b>(LOCKS)</b> Providing and fixing "Godrej Night Latch" / "Godrej Mortice Lock" in required places, all complete with fixing, fitting, etc.	Each	1.00		
5	<b>(NOTICE BOARD)</b> Providing and fixing a notice board near the Waiting area, frame to be made of 1st quality hardwood, and infill of 12 mm thick 'Celotex, board, duly covered with "Matte" quality cloth of approved colour and make. Visible surfaces of Frame to be painted with "Premium 1st Quality Paint" in approved colour and shade, and internal frames and internal surface of celotex board to be painted with priming coat. The frame is to be securely fixed to the wall, all complete as per	Each	1.00		

	directions for the Architect / Employer. Size: 3'-6" x 2'-0".				
6	<b>(MAIN ENTRANCE DOOR)</b> Providing Factory Made Aluminium Main Entrance Door of INDAL / Jindal sections, minimum section thickness of 2.5 mm all complete with swing door, fixed portion all 8mm thick glass,and 12 mm Toughened glass for opning door, coloured anodized / powder coated, as per standard aproved sections, all complete with all necessary hardware and fittings, including floor springs, door locks, etc Make.Glass (Saint Gobain glass,Modi glass,Asahi)	SQ.FT.	62.00		
7	<b>(SHUTTER BOX COVERING)</b> Sutter covering with ACP (aluminium composite panel) of approver color & make with the provision of rolling shutter maintenance trap door , all complete job as per standard & specification	SQ.FT.	78.00		
8	<b>PANELING WITH LAMINATE FINISH</b> = Providing & Fixing laminate finish paneling for walls, columns etc. made out of 2" X 1" C.P.T. Wood frame work at every 1'6" c/c ( vertical/horizontal) both ways, covered with 6mm thick commercial ply.All exposed surfaces of the paneling shall be finish with approved color 1.00 mm thk laminate complete as per detail drawing & instructions of Architect.	SQ.FT.	138.00		
9	<b>(SUGGESTION BOX)</b> Providing and fixing one suggestion box, made with 12 mm ply as per standard design and specifications of the Bank, fully complete, with enamel painting, lock, lettering on top, etc.	Each	1.00		
10	<b>(Door mat):</b> Providing one no good quality matching colour doormat and cost not exceeding	Each	1.00		
11	Providing 2 kg capacity CO2 type fire extinguisher of minimax / ceasfire / Supreme or equivalent.	Each	1.00		
12	Dust bin - steel	Each	1.00		
13	plastic chair with handle for security guard	Each	1.00		
14	<b>GYPSUM BOARD FALSE CEILING</b>	SQ.FT.	42		
i	Providing and fixing GYPSUM BOARD FALSE CEILING in levels as per the detailed drawing - made up of G.I frames as specified by Gypsum India limited and 12mm thick Gypsum board with suitable suspenders fixed to the ceiling. Ceiling section, perimeter channel, suspenders etc. shall be standard sections supplied by Gypsum India LTD. Spacing of intermediate channels shall be at 1200 mm c/c, and ceiling section at 457 mm c/c the work includes taping and jointing, applying primer, two or more coats of plastic emulsion paint of approved shade ICI/ ASHIAN PAINTS make, making cut-out for light fixtures, etc. The Final court shall be done with FOAM ROLLER, and no brush marks should be visible. Providing of perimeter channels/ beading etc. as per drawing complete in all respects.(All measurement in sqft only)				
	The rate should include necessary additional ceiling sections and intermediate channels openings for light fixtures, A.C. ducts, vertical drops, offsets.and with two coats of putty, two coats of approved primer, and three coats of approved lustre paint				
ii	Specification same as above for Vertical band of Gypsum 4" -6" BAND	R.FT.	24		
iii	<b>GRID FALSE CEILING</b>	SQ.FT.	20		

	<p>Providing and fixing of false ceilings at all heights of 600 mm x 600 mm x 10-12 mm Mineral Fibre ceiling tiles of type Premier-Beveled Tegular Edge laid on 15mm exposed grid system. The framework comprise of main runner spaced at 1200mm centers securely fixed to the structural soffit by approved hangers at 1200mm maximum centers. Hangers (GI wire of 4.0mm dia) to be fixed by approved roof plug, level adjusters and screws etc. The last hanger at the end of each main runner should not be greater than 450mm from the adjacent wall. Flush fitting 1200mm long cross tees (with double stitching) to be interlocked between main runners at 600mm centers to form 1200 x 600mm modules. Cut cross tees longer than 600mm to be supported independently. 600mm x 600mm modules to be formed by fitting 600mm long flush fitting cross tees centrally between the 1200m cross tee.(as per approved from work incharge)</p>				
	<b>TOTAL (B)</b>				
	<b>GRAND TOTAL (A+B)</b>				
	<b>G.S.T(Extra as applicable)</b>				
	<b>GRAND TOTAL</b>				
	<b>Notes:-</b>				
	Contractor to Note that:-				
a)	use approved make list material selection.				
b)	Footrests to be provided (laminated) with each table / counter without any extra charges, @ 1 per person.				
c)	Extra members, wherever required for stability / otherwise, to be provided with the required finish without ant extra charges.				

OPTION-2

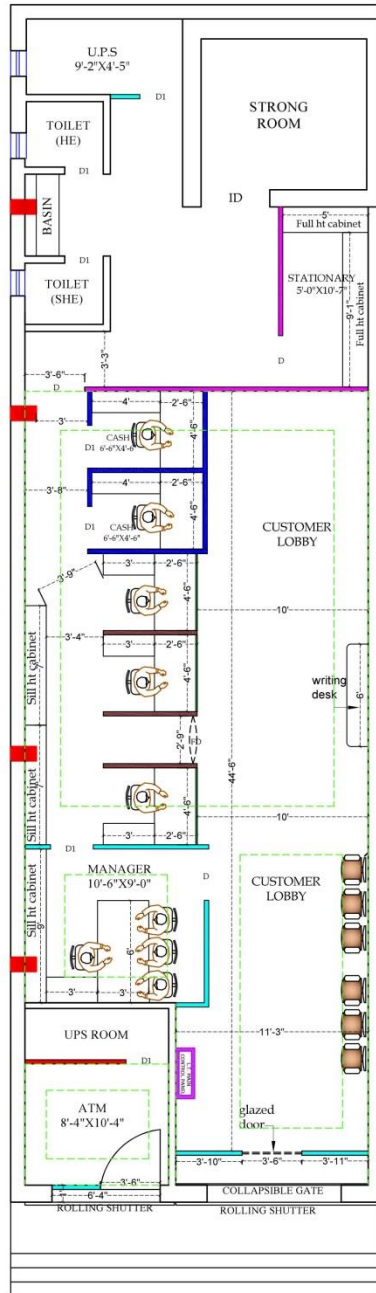

GROUND FLOOR PLAN

LAND LORD PART

NOTES

- All dimensions to be read not to be scaled.
- This drawing supersedes all other previous drawings.
- Dimensions are in inches except otherwise.
- This drawing should be read in conjunction with relevant structural drawing and any discrepancy notices should be get clarified before execution.
- The drawing is the property of the architects.
- Any copying or reproduction of this drawing should only be done after a written permission of the architects.
- Any defaulter is liable to be sued for the violation of the copyright act.

AREA CALCULATION

LEGEND:-

- HALF HT. PARTITION
- CASH CAGE PARTITION
- SEMI GLAZED FULL HT. PARTITION
- SOLID FULL HT. PARTITION
- BRICK WALL
- R.C.C WALL

PROJECT

PROPOSED INTERIOR LAYOUT OF KANTI BRANCH AT MUZ.

CLIENT

UNION BANK OF INDIA

DRAWN BY

NORTH

CHECKED BY

Niraj Kumar



SCALE

NOT TO SCALE

DATE

REVISION

07-02-24

02/20-06-24

SHEET TITLE

(ID-1)

DRAWING TITLE

INTERIOR LAYOUT

STAMP

ARCHITECT

**VastuKriti**

108, 1st Floor, Adison Arcade,  
Fraser Road, Patna - 01  
Mob. - 9905292793,  
Email :-vastukriti108@gmail.com  
vastukriti326@gmail.com



architecture  
interior  
landscaping  
planning

MAIN ROAD

## LETTER SUBMITTING TENDER

To, \_\_\_\_\_  
 \_\_\_\_\_

Dear Sir.

With reference to the tender invited by you for the Electrical work of premises of Union Bank of India, KANTI Branch and ATM under SAMASTIPUR region.

I/ We do hereby offer to execute the work under contract at the respective rates mentioned in the Schedule of quantities. I/We have seen the site, understood the general conditions of contract, schedule of quantities etc.

I /We agree to execute the work as per specification, general conditions of contract, special conditions, additional conditions, schedule of quantities etc.

I /We have deposited earnest money **Rs.5000/-** for Electrical work by demand draft which amount is not to bear any interest. We do hereby agree that this sum shall be forfeited by you in the event our tender is accepted, and I/We fail to execute the contract when called upon to do so.

I/We are understanding that you are not bound to accept the lowest or any tender that you receive.

Yours faithfully,

(SEAL & SIGNATURE OF CONTRACTOR)

1). Name of Partner (s) of the firm: \_\_\_\_\_

2). Name of banker: \_\_\_\_\_

Demand Draft No. \_\_\_\_\_ Dated \_\_\_\_\_

Tender submitted on \_\_\_\_\_ before \_\_\_\_\_ P.M

## SPECIMEN COPY OF AGREEMENT

(Subject to change in order to availability from Central Office)

**For works exceeding Rs. 10.00 Lac agreement should be drawn on stamp paper.**

## ARTICLES OF AGREEMENT:

Agreement made at \_\_\_\_\_ this \_\_\_\_\_ day of \_\_\_\_\_ between Union Bank Of India Regional Office Samastipur, 1st floor,Panchwati Complex,Mohanpur Road, Samastipur-848101 (BIHAR) herein referred to as the successful tender/contractor which expression shall include his heirs, executors, administrators and assigns of the order part. Whereas UNION BANK OF INDIA, Regional Office Samastipur, 1st Floor, Panchwati Complex, Mohanpur Road, Samastipur, Bihar-848101 is desirous of carrying out of **the Electrical work of premises of Union Bank of India, KANTI Branch and ATM**, and has caused specification etc. describing the work to be done as per schedule of quantities along with the general conditions of contract, special condition, additional conditions etc. and whereas the contractor has agreed to execute the work described in said priced schedule of quantities, general conditions of contract, special condition, additional condition at the respective rates mentioned in the priced schedule of quantities attached.

Whereas the contractor has deposited Rs. 5000/- with the UNION BANK OF INDIA, Regional office, Samastipur, 1st floor,Panchwati Complex,Mohanpur Road, Samastipur-848101 (BIHAR) as earnest money for due performance of the agreement.

## NOW IT IS HEREBY AGREED AS FOLLOWS:

1. In consideration of the payment to be made to the contractor as herein provided he shall upon and subject to the said conditions execute and complete the work as per the said conditions and priced schedule of quantities.
2. The UNION BANK OF INDIA, Regional Office Samastipur, 1st floor,Panchwati Complex,Mohanpur Road, Samastipur-848101 (BIHAR) shall pay the contractor such sums as shall become payable hereunder at the times and in manner specified in the conditions.
3. The said conditions shall be read, and form part of the agreement and the parties hereto shall respectively abide by and submit themselves to the conditions and stipulations and perform the agreement on their parts respectively on such conditions contained.
4. All disputes arising out of in any way connected with this agreement and the parties hereto shall respectively abide by and submit themselves to the conditions and stipulations and perform the agreement shall be deemed to have arisen in Samastipur and only the Court / Arbitrator in Samastipur shall have jurisdiction determine the same.
5. The several parts of this contract have read to us and fully understood by us.

(WITNESS)

UNION BANK OF INDIA, Regional Office SAMASTIPUR

(CONTRACTOR)



**SECTION-12**

THE FOLLOWING MAKE OF MATERIALS AND EQUIPMENTS SHEEL BE USED IN THE WORK. IN THE EVENT OF NON AVAILABILITY OF CERTAIN ITEMS, THE APPROVAL OF THE ARCHITECT/ELECTRICAL ENGINEER/EMPLOYER MUST BE OBTAINED IN THE WRITING PRIOR TO USING SUBSTITUTE MAKE.

LIST OF APPROVED MAKES OF ELECTRICAL ACCESSORIES & SWITCHGEARS:

<b>SL NO</b>	<b>ITEM</b>	<b>MAKE</b>
1	PVC CONDUIT & ACCESSORIES	AKG/ CAPS/MALHOTRA – ISI MARKED
2	COPPER WIRE PVC INSULATED FRLS	POLYCAB/FINOLEX/KEI /R.R.KABEL
3	MODULAR SWITCH & BOARDS	LEGRAND/ROMA/CRABTRE/PHILIPS/KOLORS
4	MCB& MCB DB	LEGRAND/ABB/HAVELLS/L&T
5	LIGHT FITTINGS/LED	PHILIPS, Magik (Century Led Ltd.)KOLORS
6	CEILING/WALL/EXHAUST FAN	KHAITAN/ HAVELL'S/CROMPTON/BAJAJ
7	MCCB	LEGRAND/ABB/HAVELLS/L&T
8	CHANGEOVER	HPL /L&T/ HAVELL'S
9	MULTIFUNCTIONAL METERS	SCHNEIDER/HPL/L&T
10	HRC FUSE	L&T/HAVELL'S /GE
11	TELEPHONE WIRE	HAVELL'S/POLYCAB
12	CALL BELL	CONA/ANCHOR
13	LT PANEL/ UPS PANEL	CPRI TESTED MANUFACTURER
14	AC CONTROLLER	LEGRAND /ROMA/CRABTRE/PHILIPS
15	Net-working hub	D-Link

<b>BILL OF QUANTITY</b>						
<b>ELECTRICAL WORKS FOR UNION BANK OF INDIA,KANTI BRANCH</b>						
	<b>BRANCH</b>					
<b>A.</b>	<b>SUB HEAD-I (WIRING)</b>					
<b>B.</b>	<b>SUB HEAD-II (DISTRIBUTION BOARDS &amp; PANELS)</b>					
<b>C.</b>	<b>SUB HEAD-III (SUPPLY OF FIXTURES &amp; FANS)</b>					
<b>D.</b>	<b>SUB HEAD-IV (SUPPLY OF CABLE MAIN &amp; SUBMAIN)</b>					
<b>E.</b>	<b>TOTAL SUB HEAD-V (SUPPLY &amp; MAKING OF EARTHPIES)</b>					
	<b>FOR BRANCH:-</b>					
	<b>FOR ATM:-</b>					
<b>Total</b>						
<b>SL. NO.</b>	<b>ITEM OF WORK</b>		<b>QTY</b>	<b>RATE</b>	<b>AMOUNT</b>	
<b>SUB HEAD - I (WIRING)</b>						
1	Wiring for light point/ fan point/ exhaust fan point/ call bell point with 1.5 sq mm FR PVC insulated copper condtr single core cable in surface/ recessed PVC conduit with modular switch, modular plate, suitable GI box and earthing the 3rd point with 1.5 sqmm FR PVC insulated copper conductor single core cable etc as reqd.	Each	51			
2	Wiring for A.C. Point with 2 x 4 sqmm FR PVC insulated copper conductor single core cable in surface/ recessed PVC conduit / PVC Casing - n Capping along with one no 4 sq mm FR PVC insulated copper conductor single core cable for loop earthing as required.	Mtr.	153			
3	Sub main for Light point Distribution Board with 4 x 4 sqmm FR PVC insulated copper conductor single core cable surface/ recessed PVC conduit / PVC Casing - n Capping along with one no 4 sq mm FR PVC insulated copper conductor single core cable for loop earthing as required.	Mtr.	21			
4	Sub Main wiring from LT Panel to UPS Panel with 2 x 6 sqmm FR PVC insulated copper conductor single core cable in surface/ recessed PVC conduit / PVC Casing - n Capping along with two no 6 sq mm FR PVC insulated copper conductor single core cable for loop earthing as required.	Mtr.	38			
5	Sub Main wiring from UPS Panel to UPS D.B. with 2 x 6 sqmm FR PVC insulated copper conductor single core cable in surface/ recessed PVC conduit / PVC Casing - n Capping along with one no 6 sq mm FR PVC insulated copper conductor single core cable for loop earthing as required.	Mtr.	25			

6	Sub Main wiring from Main Panel to RAW D.B. with 2 x 4 sqmm FR PVC insulated copper conductor single core cable in surface/ recessed PVC conduit / PVC Casing - n Capping along with one no 4 sq mm FR PVC insulated copper conductor single core cable for loop earthing as required.	Mtr.	15		
7	Wiring for UPS & RAW Power feed computer point with 2 x 2.5 sqmm FR PVC insulated copper conductor single core cable in surface/ recessed PVC conduit / PVC Casing - n Capping along with one no 2.5 sq mm FR PVC insulated copper conductor single core cable for loop earthing as required. ( 3 outlets, i.e 3 points each with 1 switch and 3 sockets shall be under one circuit	Mtr.	365		
8	Light Circuit wiring with 2 x 2.5 sqmm FR PVC insulated copper conductor single core cable surface/ recessed PVC conduit / PVC Casing - n Capping along with one no 2.5 sq mm FR PVC insulated copper conductor single core cable for loop earthing as required.	Mtr.	185		
9	Wiring for 15 amp power socket 2 x 4 sqmm FR PVC insulated copper conductor single core cable surface/ recessed PVC conduit / PVC Casing - n Capping along with one no 4 sq mm FR PVC insulated copper conductor single core cable for loop earthing as required.	Mtr.	65		
10	S/F suitable size GI box with modular plate and cover in front on surface/ in recess i/c pvdg & fixing 5 pin 5/6 amp modular socket outlet and 5/6 amps modular switch, connection, painting etc as reqd.	Set	18		
11	S/F AC controller unit consisting of one no 25 amp AC controller having overload protection starter, one no 20/25 amp SPN MCB and socket outlet, all fixed on a modular plate complete with metal box and recessed in wall as reqd.	Set	6		
12	S/F suitable size GI box with modular plate and cover in front on surface/ in recess i/c pvdg & fixing 6 pin 15/16 amp modular socket outlet and 15/16 amps modular switch, connection, painting etc as reqd.	Set	2		
13	S/F remote controlled call bell buzzer suitable for 230 V AC/ Battery operated with remote type bell push as reqd.	nos.	1		
14	SITC of computer point with 3 no. 5 pin 5/6 amp modular socket with modular type switch for UPS Power and 2 no. 5 pin 5/6 amp modular socket with modular type switch phenolic laminated sheet suitable size PVC/G.I. box. As per instruction of Bank/Ele.Er./as required.	nos.	8		
15	S/F of approved make including square face plate and M.S. housing box with RJ-45 socket etc complete in all respect including cat-6 Data cable conduits, identification of the hub				
	a) RJ-45 socket	Set.	8		
	b) Cat-6 Data cable with PVC conduit	Mtr.	185		
16	S/I/T/Commissioning of 2 Meter Patch Cord as required, all complete as per requirement.	Set.	8		
17	Supplying and drawing fixing 8 SWG copper conductor wire for loop earthing as required.	Mtr.	35		

18	Supplying, installation, testing & fixing of 20 line Net-working hub all complete as required.	Set.	1		
19	Supplying, installation, testing & fixing of 12 Line EPABX with two line telephone one set.	Each	1		
20	Supply and fixing of following sizes of PVC conduit along with accessories in surface/ recess i/c cutting the wall and making good the same in case of recessed conduit as reqd.				
	a) 20 mm	Mtr.	25		
	b) 25 mm	Mtr.	20		
<b>TOTAL SUB HEAD-I</b>					
<b>SUB HEAD - II (DISTRIBUTION BOARDS &amp; PANELS)</b>					
1	Supplying & Fixing following ways three pole and neutral sheet steel MCB DB, 415 volts on surface/ recessed complete with tinned copper busbar, neutral busbar, earth bar din bar detachable gland plate interconnections, phosphatised and powder painted i/c earthing etc as reqd. ( But without MCB / RCCB/Isolator)				
	a) 4+18 way double door TPN DISTRIBUTION BOARD	Each	0		
	b) 4+12 way double door TPN DISTRIBUTION BOARD	Each	1		
	c) 12 Way double door SPN DISTRIBUTION BOARD	Each	2		
2	S/F 5 amps to 32 amps rating 240 V 'C' series MCB suitable for inductive load of following poles in the existing MCB DB complete with connections, testing and commissioning etc as reqd.				
	a) 6/10 A 10 KA SP MCB "C"	Each	26		
	b) 40 A 10 KA FP MCB "C"	Each	1		
	c) 40 A 10 KA DP MCB "C"	Each	2		
3	SITC of indoor cubicle extensible type fully compartmentalized Distribution panel suitable for operation on 415 volts 50 Hz 3 phase 4 wire AC distribution system, suitable for 35 KA short circuit rating, confirming to IP:42 degree of protection, made up of 1.6 mm thick CRCA sheet, wall/ floor mounted, dust & vermin proof enclosure, having hinged and earthed cover on front, having neoprene gasket/ katings stuck to the doors, duly painted with 65- 75 microns thick dry epoxy powder paint after 7 tank process of degreasing, derusting etc comprising of the following switchgears complete with all interconnections with suitable size of copper strip/hard drawn PVC insulated copper cable i/c keeping the panel in position, minor civil works as necessary, painting, sign writing etc complete as required (as per specifications of Panel attached)				
3A	<b>INCOMING:</b>				
	a) 125 amp 4 pole MCCB not less than 25 KA having Thermo magnetic type release for a range of 80% to 100% for Overload and short circuit complete with rotary handle etc as reqd.: 1 no				
	b) 63 amp 4 pole heavy duty I-II-I type cubicle changeover switch: 1 no				
3B	<b>METERING:</b>				

	a) Multifunctional meter displaying A/V/PF & Hz along with 3 nos Suitable size CTs & HRC type protection fuse etc as reqd: 1 nos				
	c) LED type phase indicating lamp in phase distinguishing colors with HRC fuse : 6nos				
3C	<b>BUS BAR:</b>				
	Main Bus Bar: 4 strip 150 amp bus bar made of electrical grade copper strip enclosed in separate bus bar chamber, provided with DMC/ SMC bus bar support duly insulated with heat shrinkable sleeves in distinct colours as reqd: 1 set				
	Emergency Load Bus Bar: 4 strip 150 amp bus bar made of electrical grade copper strip enclosed in separate bus bar chamber, provided with DMC/ SMC bus bar support duly insulated with heat shrinkable sleeves in distinct colours as reqd: 1 set				
3D	<b>OUTGOINGS:</b>				
	a) 40 amp FP 10 KA D Series: 1 nos.				
	b) 40 amp SPN 10 KA D Series: 2 nos.				
	c) 25 amp SPN MCB 10 KA D series: 6 nos.				
	d) 63 A rotary type Phase selector: 2 no (Light D.B.)				
	e) 10 amp SP MCB 10 KA "B" Series-8 no.				
	f) 15 amp SPN 10 KA D series MCB: 2 nos.				
	g) 63 amp DP manual change over for ups charging 1 nos.	Set	1		
4	S/I/T/Commissioning of UPS PRIMARY & SECONDARY consist of:-25 Amps and 32Amps DP MCB with 2 Nos 32Amp power socket in MS Enclosure Box as required, all complete as per instructions of Bank / Architect.	Set	2		
<b>TOTAL SUB HEAD-II</b>					
<b>SUB HEAD - III (SUPPLY OF FIXTURES &amp; FANS)</b>					
1	Supplying of 6W/9W LED bulb suitable for indoor application.	Each	3		
2	Supplying, installation, testing & fixing of stepped type electronic fan regulator on the existing modular plate switch box i/c connection but excluding modular plate etc as reqd.	Each	2		
3	Supplying, installation, testing & fixing of 32-40W LED edge-lit luminaire/full glow suitable for armstrong ceiling and grid ceiling complete with separate electronic driver.	Each	17		
4	Supplying of 9W/12W LED batten(downlighter) suitable for indoor application.	Each	19		
5	Supplying, installation, testing & fixing of 1X20 W Led tube light fitting powder coated batten with PC tube	Each	5		
6	Supplying, installation, testing & fixing of Exhaust fan 300mm sweep HEAVY DUTY EXHAUST Fan	Each	3		
7	Supplying, installation, testing & fixing of 1200 mm sweep energy efficient ceiling fan, connection with 1.5 sqmm PVC ins copper condtr, testing, commissioning etc as reqd.	Each	2		
8	Supplying, installation, testing & fixing of oscillating and tilting type wall bracket fan of 400 mm sweep i/c fixing the same on wall, connection with 1.5 sqmm PVC insulated copper conductor, testing, commissioning etc as required.	Each	8		

9	Supplying, installation, testing & fixing of 9-12W Led square surface light.	Each	2		
<b>TOTAL SUB HEAD-III</b>					
<b>SUB HEAD - IV (SUPPLY OF CABLE MAIN &amp; SUBMAIN)</b>					
1	Supply & laying for sub main from L.T line & DG line following sizes and core PVC/XLPE insulated PVC sheathed, heavy duty, armored electrical cable with aluminum conductor for working voltage up to and including 1100 volts.(Conforms toIS:1554.part-1) with 8 no. SWG die bare copper conductor wire for loop earthing, proper laying on wall or roof, thumbnail clipping and use proper size cable gland for cable sport etc. as required. all complete as per instructions of Elec.Er. / Architect.				
	(i) 50sq mm,3.5 core(L.T. Main)	Mtr.	30		
	(ii)25sq mm,4core (D,G Main )	Mtr.	25		
<b>TOTAL SUB HEAD-IV</b>					
<b>SUB HEAD - V (SUPPLY &amp; MAKING OF EARTHPIES)</b>					
1	Earthing with GI earth plate 600mm x 600mm x 6 mm thick accessories and pdg masonry enclosure with cover plate having locking arrangement and watering pipe etc ( but without charcoal or coke and salt) complete as required.	Set	2		
2	Extra for using charcoal and sal for GI / copper earth plate electrode as required ( 96 Kg charcoal & 5 Kg salt)	Set	2		
3	Providing & laying earth connection from earth electrode with 6 SWG dia GI wire in 15 mm dia. GI pipe from earth electrode as required.	Mtr.	20		
4	S/L 6 SWG G.I.wire on surface or in recess as reqd.	Mtr.	20		
5	Earthing with CU earth plate 600mm x 600mm x 3 mm thick accessories and pdg masonry enclosure with cover plate having locking arrangement and watering pipe etc ( but without charcoal or coke and salt) complete as required.	Set	2		
6	Extra for using charcoal and sal for GI / copper earth plate electrode as required	Set	2		
7	Providing & laying earth connection from earth electrode with 4 mm dia copper wire in 15 mm dia. GI pipe from earth electrode as required.	Mtr.	20		
8	S/L 4 mm dia copper wire on surface or in recess as reqd.	Mtr.	20		
				<b>Total:-</b>	

**BILL OF QUANTITY**  
**ELECTRICAL WORKS FOR UNION BANK OF INDIA, KANTI BRANCH (ATM)**

SL. NO.	ITEM OF WORK	UNIT	QTY	RATE	AMOUNT
<b>SUB HEAD - I (WIRING)</b>					
1	Wiring for light point/ fan point/ exhaust fan point/ call bell point with 1.5 sq mm FR PVC insulated copper condtr single core cable in surface/ recessed PVC conduit with modular switch, modular plate, suitable GI box and earthing the 3rd point with 1.5 sqmm FR PVC insulated copper conductor single core cable etc as reqd.	Each	6		
2	Wiring for A.C. Point with 2 x 4 sqmm FR PVC insulated copper conductor single core cable in surface/ recessed PVC conduit / PVC Casing - n Capping along with one no 4 sq mm FR PVC insulated copper conductor single core cable for loop earthing as required.	Mtr.	15		
3	Wiring for UPS fed computer point with 2 x 2.5 sqmm FR PVC insulated copper conductor single core cable in surface/ recessed PVC conduit / PVC Casing - n Capping along with one no 2.5 sq mm FR PVC insulated copper conductor single core cable for loop earthing as required. ( 3 outlets, i.e 3 points each with 1 switch and 3 sockets shall be under one circuit	Mtr.	25		
4	Circuit wiring with 2 x 2.5 sqmm FR PVC insulated copper conductor single core cable surface/ recessed PVC conduit / PVC Casing - n Capping along with one no 2.5 sq mm FR PVC insulated copper conductor single core cable for loop earthing as required.	Mtr.	30		
5	S/F suitable size GI box with modular plate and cover in front on surface/ in recess i/c pvdg & fixing 5 pin 5/6 amp modular socket outlet and 5/6 amps modular switch, connection, painting etc as reqd.	Set	3		
6	S/F AC controller unit consisting of one no 25 amp AC controller having overload protection starter, one no 20/25 amp SPN MCB and socket outlet, all fixed on a modular plate complete with metal box and recessed in wall as reqd.	Set	2		
7	S/F suitable size GI box with modular plate and cover in front on surface/ in recess i/c pvdg & fixing 6 pin 15/16 amp modular socket outlet and 15/16 amps modular switch, connection, painting etc as reqd.	Set	3		
8	S/F wiring 3no. 5 pin 5/6 amp modular socket with modular type switch, phenolic laminated sheet suitable size PVC/G.I. box from UPS power one no. 2 pair telephone wire from EPABX to telephone jack RJ-11 socket.As per instruction of Bank/Ele.Er./as required.	nos.	2		
9	Supplying and drawing fixing 8 SWG copper conductor wire for loop earthing as required.	Mtr.	10		
10	S/I/T/Commissioning of 2 Meter Patch Cord as required, all complete as per requirement.	Set.	2		
	<b>TOTAL SUB HEAD-I</b>				

<b>SUB HEAD - II (DISTRIBUTION BOARDS &amp; PANELS)</b>					
1	SITC of indoor cubicle extensible type fully compartmentalized Distribution panel suitable for operation on 415 volts 50 Hz 3 phase 4 wire AC distribution system, suitable for 35 KA short circuit rating, confirming to IP:42 degree of protection, made up of 1.6 mm thick CRCA sheet, wall/ floor mounted, dust & vermin proof enclosure, having hinged and earthed cover on front, having neoprene gasket/ katings stuck to the doors, duly painted with 65- 75 microns thick dry epoxy powder paint after 7 tank process of degreasing, derusting etc comprising of the following switchgears complete with all interconnections with suitable size of copper strip/hard drawn PVC insulated copper cable i/c keeping the panel in position, minor civil works as necessary, painting, sign writing etc complete as required (as per specifications of Panel attached)				
	<b>INCOMING:</b>				
	a) 63 amp 4 pole MCCB not less than 25 KA having Thermo magnetic type release for a range of 80% to 100% for Overload and short circuit complete with rotary handle etc as reqd.: 1 no				
	<b>METERING:</b>				
	a) Multifunctional meter displaying A/V/PF & Hz along with 3 nos Suitable size CTs & HRC type protection fuse etc as reqd: 1 nos				
	c) LED type phase indicating lamp in phase distinguishing colors with HRC fuse : 6nos				
	<b>BUS BAR:</b>				
	Main Bus Bar: 4 strip 150 amp bus bar made of electrical grade copper strip enclosed in separate bus bar chamber, provided with DMC/ SMC bus bar support duly insulated with heat shrinkable sleeves in distinct colours as reqd: 1 set				
	<b>OUTGOINGS:</b>				
	a) 63 A rotary type Phase selector: 1 no				
	b) 40/63 amp SPN MCB 10 KA D series: 2 nos ( UPS + spare)				
	c) 25 amp Single pole & Neutral MCB 10 KA D Series: 2 nos (For AC)				
	d) 10 A SP MCB- 2 no. (For Light CKT)				
	e) 1 no 40 A SPN MCB 10KA with 1 no 40 amp Industrial type socket out let and Top with connection for input switch from selector switch and between out put switch to o/g MCB with PVC insulated copper condtr wire as reqd: 2 nos ( for UPS input & Output from UPS)	Each	1		
	<b>TOTAL SUB HEAD-II</b>				
<b>SUB HEAD - III (FIXTURES &amp; FANS)</b>					
1	Supplying of 6W/9W LED batten suitable for indoor application.	Each	1		



2	Supplying, installation, testing & fixing of 32-40W LED edge-lit luminaire/full glow suitable for armstrong ceiling and grid ceiling complete with separate electronic driver.	Each	1		
3	Supplying of 9W/12W LED batten(downlighter) suitable for indoor application.	Each	4		
4	Supplying, installation, testing & fixing of 1X20 W Led tube light fitting powder coated batten with PC tube	Each	0		
5	Supplying, installation, testing & fixing of oscillating and tilting type wall bracket fan of 400 mm sweep i/c fixing the same on wall, connection with 1.5 sqmm PVC insulated copper conductor, testing, commissioning etc as required.	Each	1		
<b>TOTAL SUB HEAD-III</b>					
<b>SUB HEAD - IV (CABLE MAIN &amp; SUBMAIN)</b>					
1	Supply & laying for sub main from L.T line & DG line following sizes and core PVC/XLPE insulated PVC sheathed, heavy duty, armored electrical cable with aluminum conductor for working voltage up to and including 1100 volts.(Conforms to IS:1554.part-1) with 8 no. SWG die bare copper conductor wire for loop earthing, proper laying on wall or roof, thumbnail clipping and use proper size cable gland for cable sport etc. as required. all complete as per instructions of Elec.Er. / Architect.				
	(i)16sq mm,4core	Mtr.	10		
<b>TOTAL SUB HEAD-IV</b>					
<b>SUB HEAD - IV (EARTH PITS)</b>					
1	Earthing with GI earth plate 600mm x 600mm x 6 mm thick accessories and pdg masonry enclosure with cover plate having locking arrangement and watering pipe etc ( but without charcoal or coke and salt) complete as required.	Set	1		
2	Extra for using charcoal and sal for GI / copper earth plate electrode as required ( 96 Kg charcoal & 5 Kg salt)	Set	1		
3	Providing & laying earth connection from earth electrode with 6 SWG dia GI wire in 15 mm dia. GI pipe from earth electrode as required.	Mtr.	20		
4	S/L 6 SWG G.I.wire on surface or in recess as reqd.	Mtr.	20		
<b>TOTAL SUB HEAD-IV</b>					
			<b>Total (B):-</b>		

SECTION-14

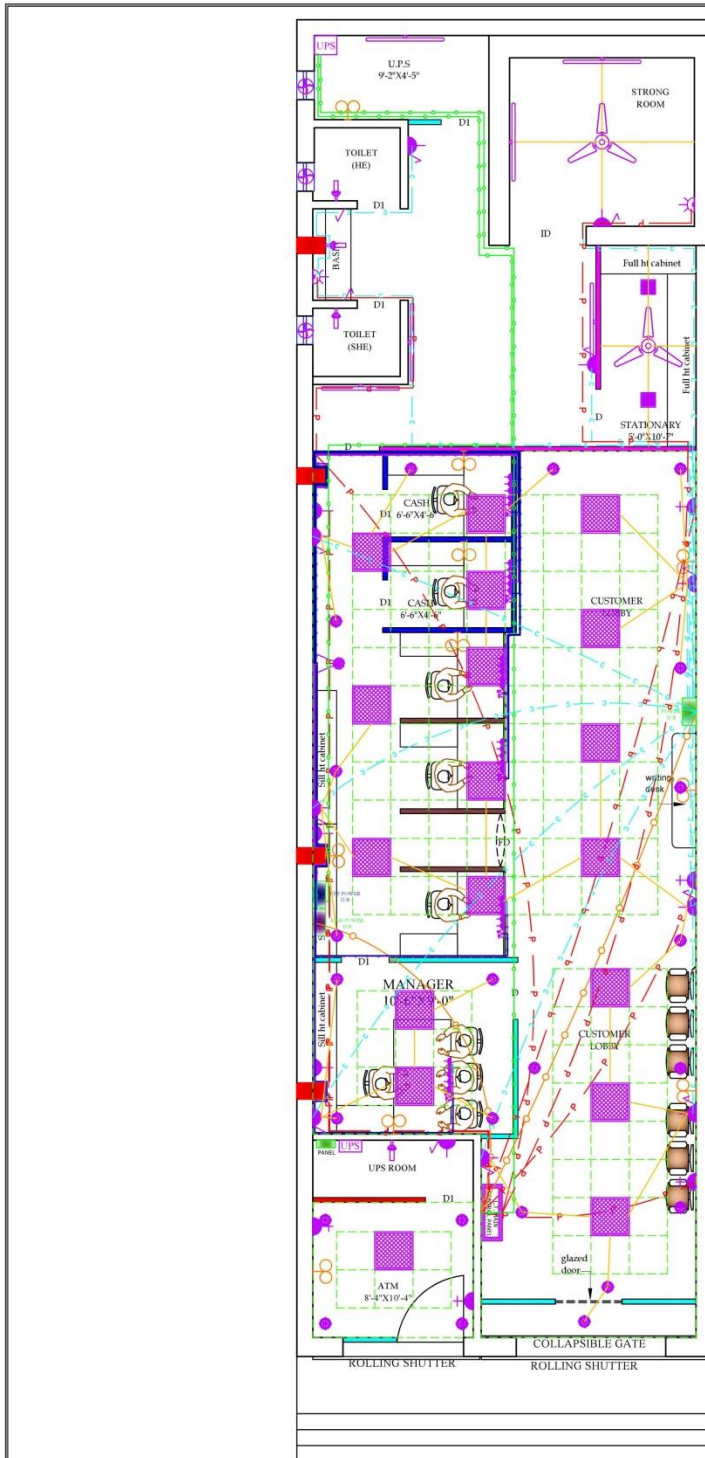

GROUND FLOOR PLAN

MAIN ROAD

- NOTES
- \* THIS DRAWING IS PROPERTY OF VASTUKRITI MUST NOT BE RETAINED, COPIED, REPRODUCED IN ANY FORM WITHOUT WRITTEN PERMISSION OF VASTUKRITI
  - \* USE ARCHITECTURAL DRAWING FOR DETAIL DIMENSIONS.
  - \* IN CASE OF ANY DISCREPANCY IN THIS DRAWING OR DIFFICULTY IN ANY BITS THIS OFFICE SHOULD BE REFERRED.
  - \* DIAMETER OF SUB MAIN CONDUIT IS 1" AND REMAINING ARE OF 0.75"

SCHEDULE OF LEGEND

SYMBOL	DESCRIPTION
	9/12 WATT LED BULB
	EXHAUST FAN POINT
	NETWORKING HUB
	E.P.B.X (TELEPHONE HUB)
	2x2 32/40 WATT LED LIGHT
	20 WATT (LED TUBE LIGHT)
	CEILING FAN
	5/6 AMP. 5 PIN SWITCH & SOCKET
	WALL FAN POINT
	25 Amp. A.C. POWER SOCKET
	15 Amp. 5 PIN POWER SOCKET
	SWITCH BOARD WITH 5 AMP. SOCKET
	DISTRIBUTION BOARD (LIGHT/RAW/UPS)
	L.T. MAIN CONTROL PANEL
	CALL BELL
	UPS PRIMARY & SECONDARY PANEL
	WAY FOR POINT WIRING.
	WAY FOR NETWORKING & TELEPHONE.
	WAY FOR SUB MAIN WIRING.
	WAY FOR POWER POINT WIRING.
	WAY FOR CIRCUIT WIRING.
	WAY FOR RAW POWER WIRING.
	WAY FOR UPS POWER WIRING.
	LED Panel light designed for false ceiling suitable for watt fluorescent led lamp size (2'x2') complete as /boq
	9/12 Watt led down light
	9-12 WATT LED SQUARE SURFACE LIGHT
	TEL POWER
	DATA POWER
	UPS POWER
	UPS POWER
	RAW POWER
	RAW POWER

PROJECT

PROPOSED ELECTRICAL LAYOUT OF KANTI BRANCH

CLIENT

UNION BANK OF INDIA

DRAWN BY

NORTH

CHECKED BY



SCALE

NOT TO SCALE

DATE

REVISION

27-06-24

SHEET TITLE

(ED-1)

DRAWING TITLE

ELECTRICAL LAYOUT

STAMP

ARCHITECT

VastuKriti

108, 1st Floor, Adison Arcade,  
Fraser Road, Patna - 01  
Mob: - 9905292793,  
Email: -vastukriti108@gmail.com  
vastukriti326@gmail.com



architecture  
interior  
landscaping  
planning